

Testing Procedure

For COVID-19 Antigen Rapid Test (Latex)

I. Posterior oropharyngeal saliva/Sputum sample

Please read the instructions carefully and allow the test device and specimens to equilibrate to temperature (15°C-30°C) prior to testing.

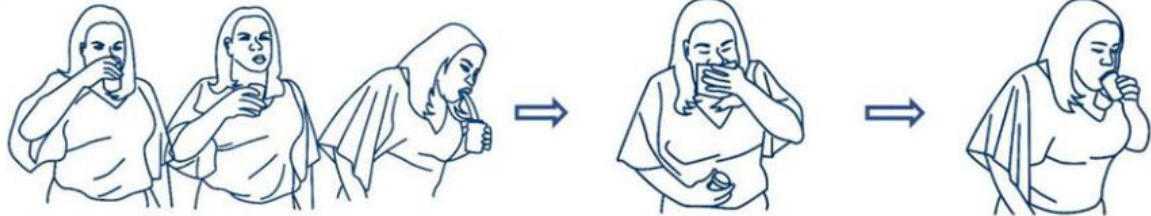

1. Rinse and spit with water. This is important to make sure there won't be mouth bacteria in the sputum collected.

"It is recommended to collect Sputum/oropharyngeal saliva in early-morning (first thing in the morning upon awakening, before teeth brushing, mouth rinsing, and eating breakfast)"

2. Cough deeply. Make the noise of "Kruuuu" from the throat to clear sputum/oropharyngeal saliva from deep throat.

3. Once the sputum/oropharyngeal saliva is in your mouth, release it into the container. Repeat 3~4 times to collect enough sample

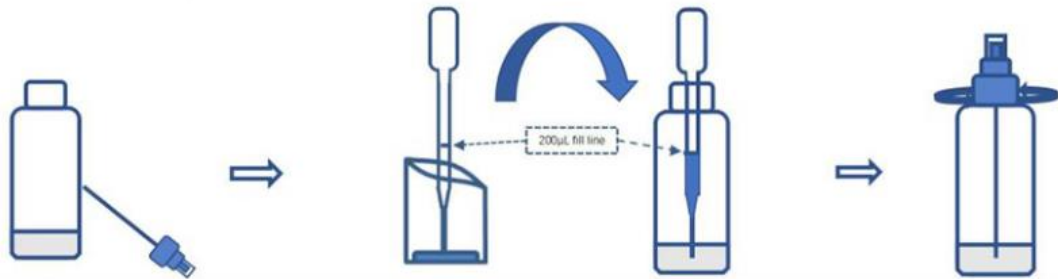

4. Unscrew the Sample Extraction Tube

5. Transfer 200µL of fresh Sputum/oropharyngeal saliva samples from container into the Sample Extraction Tube.

6. Tighten the sample extraction tube

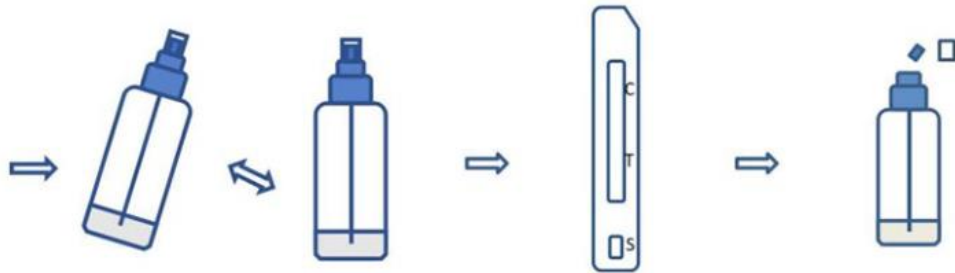

7. Shake and mix completely

8. Take the test cassette from the packaging bag, place it on a table

9. Cut off the protrusion of the collection tube

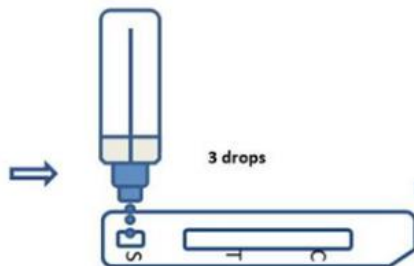

10. Add 3 drops of the sample into the sample hole vertically

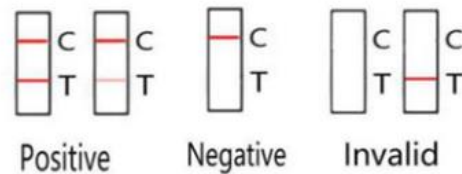

11. Read the result after 15 minutes. If left unread for 20 minutes or more, the results are invalid, and a repeat test is recommended.